

Neat Frame

User Manual



neat.

Neat Frame

Video conferencing device with integrated touch screen



Neat Frame packs powerful technology into an all in one compact and convenient meeting device that enables you to free up your computer for other tasks.

A portrait-oriented touch screen, advanced camera, speakers, microphones, and environmental sensors, help deliver superior-quality audio, video and other unique capabilities to your personal space and focused meeting areas.

Neat Frame is a stand-alone device that also supports wired and wireless headsets.

Everything you need

Neat Frame comes with everything you need to get started.

In the box

Neat Frame: Video conferencing device with integrated touch screen.

Power cord: 9.8ft (3m)



Size & weight

Weight: 7.6 pounds (3.45 kg)

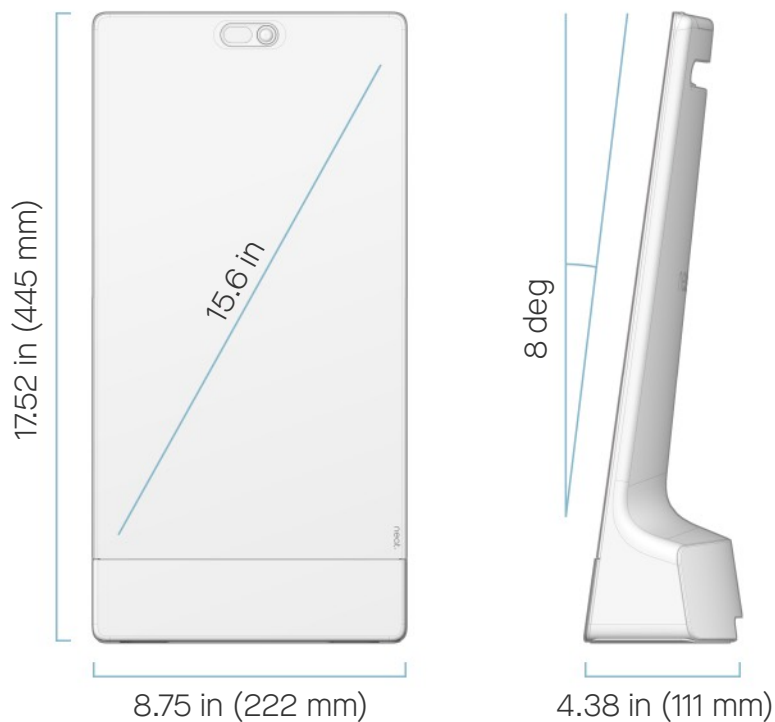

Setup & connectivity

Setup

Use the provided cables to set up the system. Connect the cables according to the illustration. Cables marked — are included. Cables marked ---- are optional and not required for basic use of the system.

Requirements for a complete setup

Internet connection
Video service

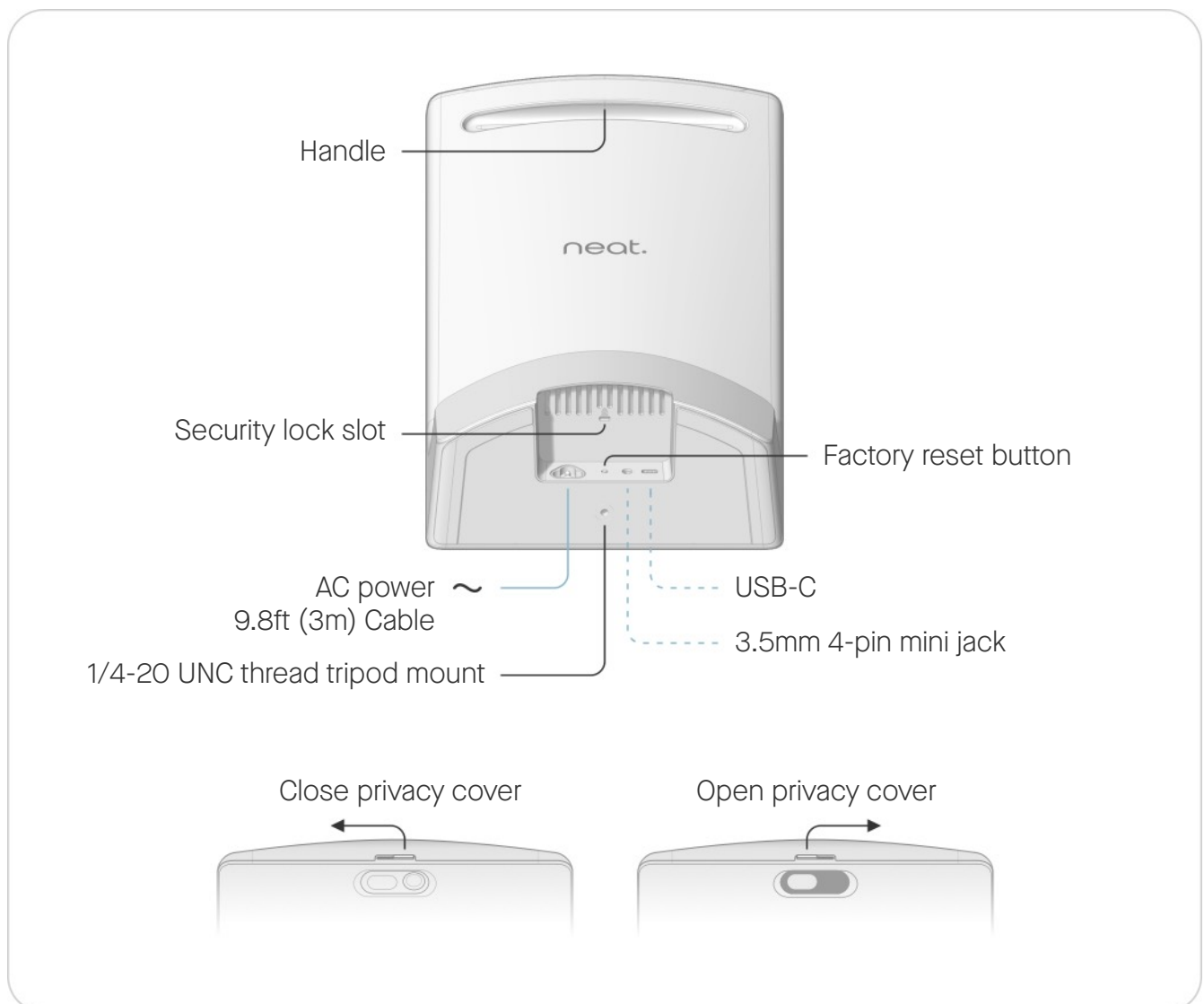

Environmental Requirements

Ambient operating temperature:
32° to 95° F (0° - 35° C)
Storage temperature: 5° - 149° F (-15° - 65° C)
Relative humidity: 20% to 80%
Network standby: 8W

Additional Product Information

<https://neat.no/frame>